

MA stainless steel micro cylinder ISO6432

Home >> Products >> Air cylinder >> Micro cylinder >> MA stainless steel micro cylinder ISO6432:



Product description:

MA metal micro cylinder is made from stainless steel. MAD is double-rod and MAJ is adjustable double-rod. Also, we have single action and double action. The end caps are rolled together with the tube. The advantages are: light weight, compact, wearable and long working life. The bore is from 16mm to 40mm.

Ordering Code

MA	C	U	25X	50	-25	-S	-LB
Type	Code	Back	CoverCylinder	Stroke	MAJ:Adjustable	Magnet	Fixed Type
MA:Double Action	Blank:Cushion	Type	Bore	Stroke	Type	Code	Blank:Basic
MSA:Single Action	C:Air Cushion	Blank:Fishtail				Not Attach	Type
MAD:Double-shaft		Type				Magnet	LB:Front and
Double Action		U:Horizontal				S:Attach	Back Fixed
MAJ:Double-shaft		Type				Magnet	Type
and		CM:Rounded					FA:Front Cover
Adjust able stroke		Type					Fixed Type
type							SDB:Back
							Cover Swing
							Type

Specification

Bore	16	20	25	32	40
Motion Pattern	Double Action				
Working Medium	Air				
Fixed Type	基本型/Basic Type 、 FA Type 、 LB Type、 SDB Type				
Operating Voltage Range	1-9Kgf/cm ²				
Ensured Pressure Resistance	13.5Kgf/cm ²				
Operating Temperature Range	0-70°C				
Operating Speed Range	50-800mm/s				

Buffer Stroke
Joint Pipe Bore

Buffer Spacer
M5×0.8 G1/8

Cylinder Theory Output Sheet

Cylinder Inside Diameter	16			20		
	Single Action	Double Action Extrusion Side Pull Side		Single Action	Double Action Extrusion Side Pull Side	
Motion Pattern						
Compression Area(cm2)	2.01	2.01	1.81	3.14	3.14	2.64
	1 -	2.01	1.81	-	3.14	2.64
	2 -	4.02	3.62	1.57	6.28	5.28
	3 2.01	6.03	5.43	4.71	9.42	7.92
	4 4.02	8.04	7.24	7.85	12.56	10.56
Air Pressure (Kgf/cm2)	5 6.03	10.05	9.05	10.99	15.70	13.20
	6 8.04	12.06	10.86	14.13	18.84	15.84
	7 10.04	14.07	12.67	17.27	21.98	18.48
	8 -	-	-	20.41	25.12	21.12
	9 -	-	-	23.55	28.26	23.76

Cylinder Inside Diameter	25			32			40		
	single action	Double Action Extrusion Side Pull Side		single action	Double Action Extrusion Side Pull Side		single action	Double Action Extrusion Side Pull Side	
Motion Pattern									
Compression Area(cm2)	4.9	4.9	4.12	8.04	8.04	6.9	12.56	12.56	10.55
	1 -	4.9	4.12	-	8.04	6.9	-	12.56	10.55
	2 2.45	9.80	8.24	4.02	16.08	13.80	6.28	25.12	21.10
	3 7.35	14.70	12.36	12.06	24.12	20.70	18.84	37.68	31.65
	4 12.25	19.60	16.48	20.10	32.16	27.16	31.40	50.24	42.20
Air Pressure (Kgf/cm2)	5 17.15	24.50	20.60	28.14	40.20	34.50	43.96	62.80	52.75
	6 22.05	29.40	24.72	36.18	48.24	41.40	56.52	75.36	63.30
	7 26.95	34.30	28.84	44.22	56.28	48.30	69.08	87.92	73.85
	8 31.85	39.20	32.96	52.26	64.32	55.20	81.64	100.48	84.40
	9 36.75	44.10	37.08	60.30	72.36	62.10	94.20	113.04	94.95

Stroke

Bore(mm) Standard Stroke

Max.Stroke

Penmissble Stroke

16	25 50 75 100 125 150 175 200	300	500
20	25 50 75 100 125 150 175 200 250 300	500	650
25	25 50 75 100 125 150 175 200 250 300 350 400 450 500	500	650
32	25 50 75 100 125 150 175 200 250 300 350 400 450 500	500	650
40	25 50 75 100 125 150 175 200 250 300 350 400 450 500	500	650

Dimension Sheet

TYPE: MA复动型 MADouble Action

TYPE: 基本型
Basic type

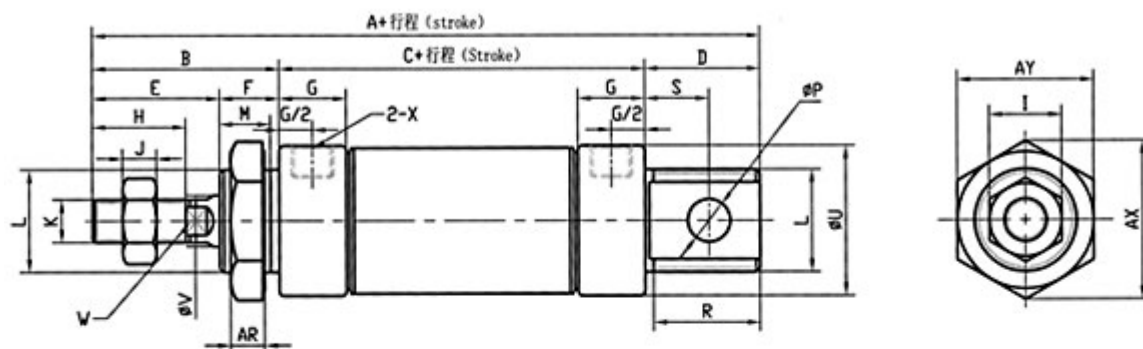

TYPE: 平尾型
Horizontal type

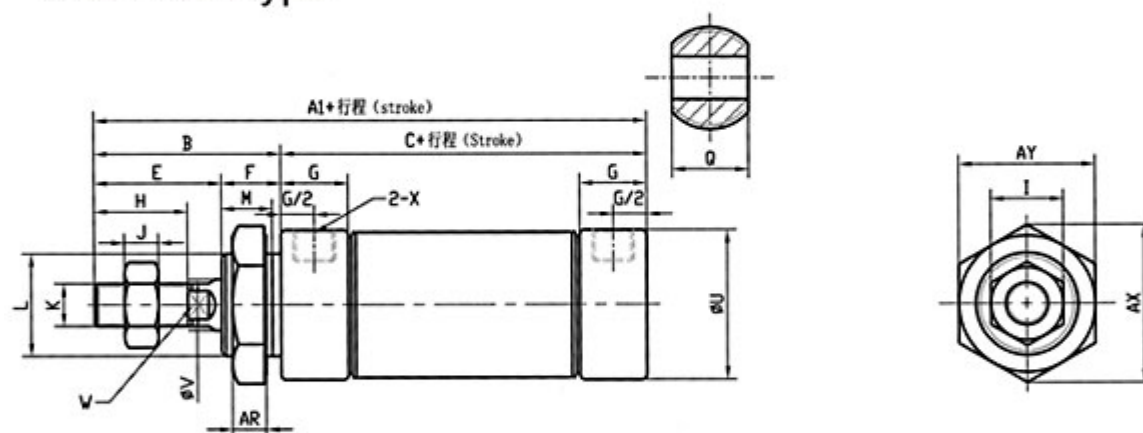

TYPE: 双轴型
Double axis type

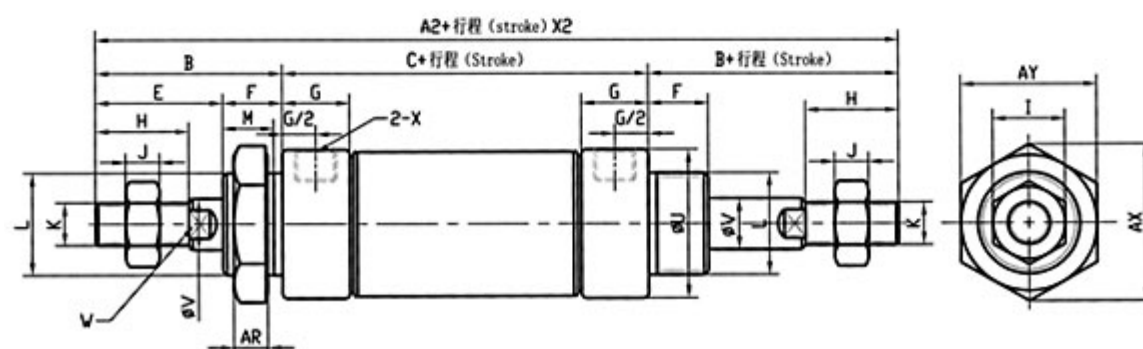

TYPE: 双轴可调型

Dimension Sheet

Bore	A	A1	A2	A3	B	C	D	E	F	G	H	I	J	K
16	114	98	136	135	38	60	16	22	16	10	16	10	5	M6×1
20	137	116	156	153	40	76	21	28	12	16	20			

Company Information:

Company Name:

Ningbo Lida Pneumatic Kit Co.,Ltd.

Website:<http://www.cn-lida.com>

Address:

Eighth Quarter, Zhongxing East Road, Xikou, Fenghua, Zhejiang, China.

Post-code:315500

Contact Person:Lacey Liu exporting manager

Phone:

Telephone:0086-574-88846388

Fax:0086-574-88846288

Email:export@nblida.cn